

# EcoHut 1A Display





# EcoHut 1A Display

ECOLIV®

Perfect for luxury tourist accommodation, eco-friendly retreat or even a contemporary home studio, this luxury award-winning modular EcoHut seamlessly adapts to your needs, providing a versatile and comfortable space to suite your lifestyle.

## Elevate your lifestyle with a touch of sustainable luxury.

Like all Ecoliv homes, our EcoHut 1A is designed for living harmoniously and integrating with the natural Australian environment. Impress your guests with hallmarks of sophistication such as Tasmanian oak engineered flooring, benchtops made from recycled glass bottles, a Biofuel fireplace and off-grid service capabilities.

Crafted with precision from responsibly sourced, renewable, and resilient building materials along with limiting wastage during the construction process, the EcoHut 1A addresses the needs of the present without compromising the future.

The EcoHut 1A also complies with the new Labour Governments planning reforms aimed at boosting housing supply in Victoria. A planning permit from Council is no longer required if the home is under 60 square meters and on a property of 300 square meters or larger.

Your chance to own this ready-to-deliver EcoHut 1A is here.

Call our Sales Consultant today on +61 (3) 5672 5196 or schedule a visit to experience the EcoHut 1A firsthand. [CLICK HERE TO BOOK AN APPOINTMENT](#)







1A

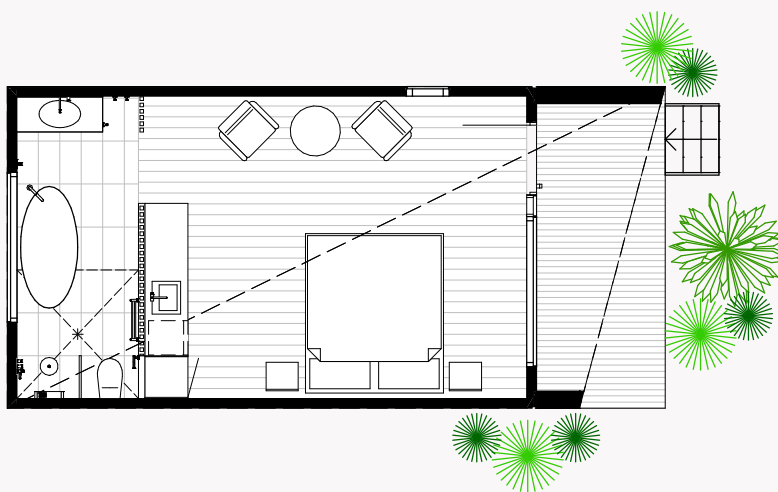

### EcoHut 1A

Modules	1
Area	33.88m <sup>2</sup>
Deck	7.52m <sup>2</sup>
Length	9.20m
Width	4.50m
Height	3.7m
Price	\$200,000 + GST

# Inclusions

## ENERGY EFFICIENCY / SUSTAINABILITY

- 7 Star energy rating
- Zero carbon footprint Weathertex cladding
- Sealing with Thermakraft vapour permeable membrane
- Energy efficient hot water system
- Double glazed argon filled aluminium windows and sliding doors
- Low VOC paints and sealers
- Low VOC custom cabinetry
- WELS rated plumbing fixtures
- LED downlights
- Bulk insulation - ceiling R6 batts, walls R2.5, floor R6. (subfloor sealed)

## SITE & FOUNDATIONS

- Footings (to class 'M' soil classification)
- 600mm diameter bored pier concrete pad with galvanised steel stumps to 400mm high
- Connection of services available from perimeter of building
- NCC termite treatment

## EXTERIOR

- NCC compliant structure (local, state and national compliance)
- Plantation pine frames and trusses
- Standing seam profile colorbond colour roofing and accessories
- Zero carbon footprint Weathertex cladding
- Australian made Haymes Low VOC paint finish to all external surfaces (one colour)
- AWS powder coated aluminium double-glazed windows and sliding door units
- Fly screens to all openable windows and sliding doors
- 1020 solid core entry door with feature handle

- Australian hardwood decking + external steps as detailed in floorplan
- BAL (Bushfire Attack Level) 19 construction
- Wind rating to N2

## INTERIOR

- 3100mm max ceiling height timber lined
- 10mm plasterboard to walls
- Insulation to external walls, floors and ceilings
- Eazypine 67mm square set skirting and architraves
- Villaboard (water resistant) to bathroom
- Redicote 2400mm hinged internal doors with brushed chrome lever door furniture
- Cushion door stops to all doors opening on to walls
- Tasmanian Oak 14.3mm engineered timber flooring with Bona low VOC scratch resistant finish
- Australian made Haymes low VOC paint finish to all internal surfaces (one colour)

## KITCHENETTE

- 20mm recycled glass benchtops
- Low VOC custom cabinetry
- Single bowl stainless steel sink
- Phoenix taps WELS rated water saving brushed nickel flick mixer
- Tiled splashback
- 2 compartment recycling bin and cutlery tray insert

## BATHROOM

- 20mm recycled glass benchtops
- Low VOC custom cabinetry
- White solid surface basin and bath
- LED backlit wall mirror with magnifying panel
- Waterproofing to all tiled areas
- 600x300 ceramic floor and wall tiles to wet areas full high to 3 shower walls
- 600x300 ceramic tiled shower base set in floor
- Phoenix taps WELS rated water saving brushed nickel flick mixer
- WELS rated water saving low-level toilet suites

## ELECTRICAL & SAFETY

- Kitchenette 1x GPO
- Living 1x GPO, 2x downlights,
- Bathroom 1x GPO, 1x exhaust fan/light/heater
- Bedroom 3x GPO
- 1x Marshall LED Exterior Wall Light.
- Smoke detectors hard wired w/ battery backup
- Energy saving LED globes to all downlights
- 250 Liter hot water system

## EXCLUSIONS POA

- Transport/Crane delivery Fees
- Preliminary Site Visit
- Town Planning Drawings (if required)
- Energy Rating
- Domestic Building Insurance
- Excavation of site (if required)
- Driveway construction
- Service connections
- Balustrade/handrails

Please note: Secondary dwellings and Extension projects to be connected to existing services.

**\$15,000**  
**of free upgrades**

- Panasonic split system
- External Colorbond
- Enseam cladding
- EcoSmart fireplace
- DIY linen curtains

# ECOLIV<sup>®</sup>

---

Eco modular homes

# Live the dream, naturally

## Contact us

The EcoHub Display Centre  
1114 Bass Hwy, The Gurdies  
VIC 3984

Phone +61 (3) 5672 5196  
Email [info@ecoliv.com.au](mailto:info@ecoliv.com.au)  
Visit [ecoliv.com.au](http://ecoliv.com.au)

## Join our community

